

- ORIGINAL ROUTE :**
- Approximately 250 lineal feet of elevated walkway within the regulated wetland areas
 - Minimizes improvements in regulated wetlands and floodway
- ALTERNATIVE A :**
- Approximately 1,280 lineal feet of elevated walkway within the regulated wetland areas
 - Relocated pedestrian bridge from original location further west, more trail located on north side of river, requires further floodplain and hydraulic analysis
 - Route not as direct due to minimizing structure located within regulated floodway limits
 - Additional topographical survey and wetland delineation would be required (outside of limits of survey originally completed)
 - Additional geotechnical investigation required
 - Construction access to bridge location is difficult for delivery and installation
 - Eliminates ability for future connection to Flower Hospital Secondary Trail
- ALTERNATIVE B :**
- Approximately 1,100 lineal feet of elevated walkway within regulated wetland areas
 - Allows users closer to river while remaining out of floodway
 - Additional geotechnical investigation required
 - Maintains ability for future connection to Flower Hospital Secondary Trail

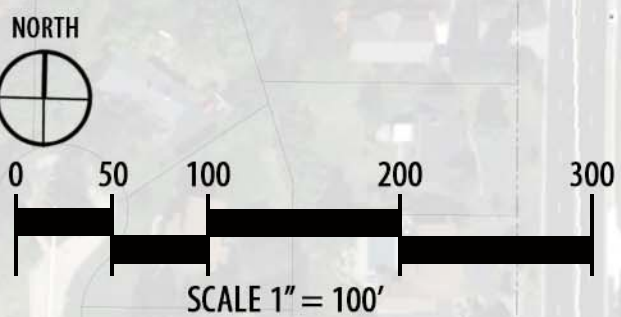

ORIGINAL TRAIL ALIGNMENT

TRAIL ALIGNMENT ALTERNATIVE A

TRAIL ALIGNMENT ALTERNATIVE B

PROMEDICA EBEID HOSPICE RESIDENCE

PROMEDICA GOERLICH CENTER

US-23

BEGIN ELEVATED TRAILWAY ORIGINAL ALIGNMENT

POTENTIAL CONNECTION TO FLOWER HOSPITAL TRAILS

BEGIN ELEVATED TRAILWAY ALT. A & B